

UPPER FLOOR
698 SQ. FT.

8'-0" - 16'-1" CEILING HEIGHTS

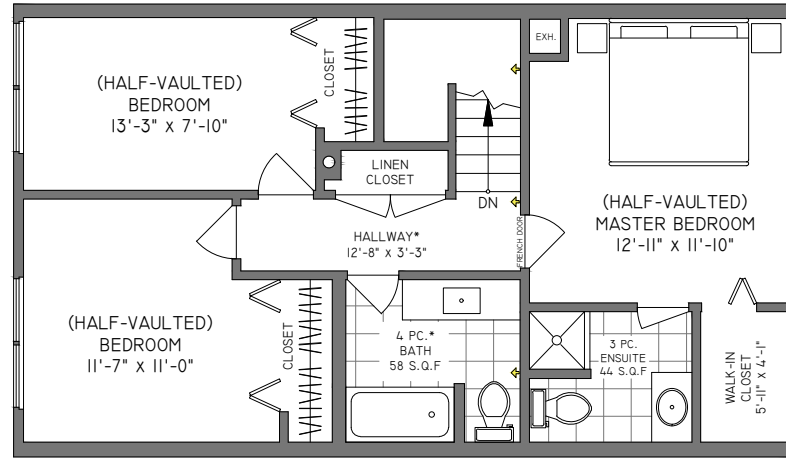

*NATURAL LIGHT COMES THROUGH CLERESTORY WINDOW

MAIN FLOOR
784 SQ. FT.

7'-0" - 8'-0" CEILING HEIGHTS

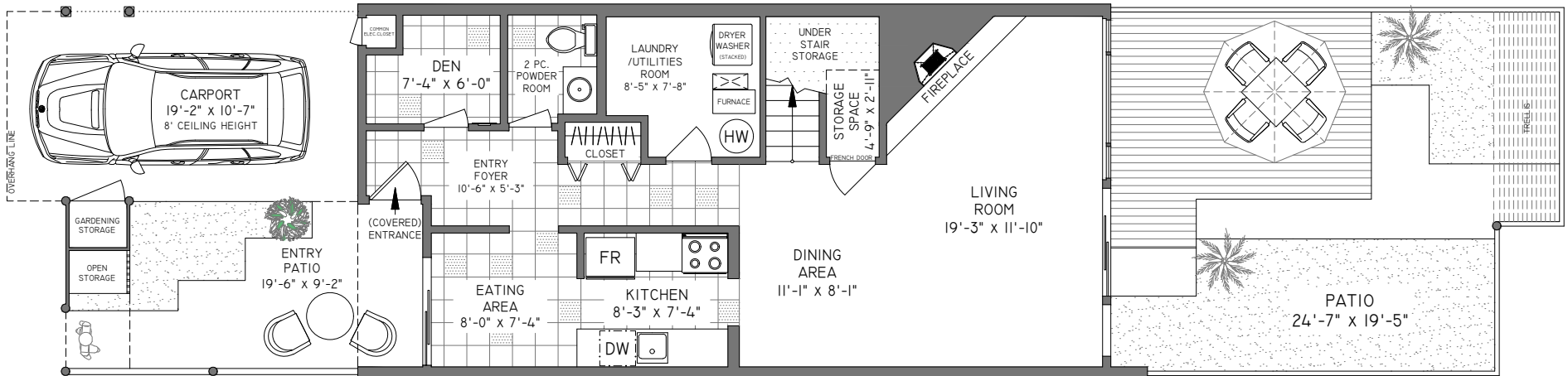

#31 - 11391 7TH AVENUE, RICHMOND

FLOOR	AREA (SQ. FT.)		
	FINISHED	CARPORIT	PATIO
MAIN	784	202	648
UPPER	698	-	-
TOTAL	1482	202	648

